

# breaking ground: **The School of Public Health, Imperial College London**

Imperial College London's new School of Public Health building officially broke ground yesterday. Designed by Allies and Morrison, the building will provide the School with a new, collaborative, and flexible home within Imperial's White City campus with 7,940 sqm (GIA) of accommodation on an important site on the campus' North Site. The new building has been designed to address both the central square at the heart of the north campus while contributing to the changing setting of Wood Lane.

The virtual groundbreaking was presided over by Professor Alice P Gast, President of Imperial College London, and Professor Deborah Ashby, Director of the School of Public Health and Founding Co-Director of the Imperial Clinical Trials Unit. The event also brought together professors from across the School and the wider College community for a panel discussion about the School's future vision. These included Professor Neil Ferguson, Director of the Jameel Institute and author of some of the most influential reports on controlling Covid-19 in the UK.

This is a landmark moment in Imperial's £100m Transforming Health and Wellbeing fundraising campaign, which has raised more than £57 million to date.

The Transforming Health and Wellbeing fundraising campaign is amplifying work across four key areas: World Health, Food and Nutrition, Community Health and Policy, and Children's Health and Wellbeing, and includes the creation of the new School for Public Health building.

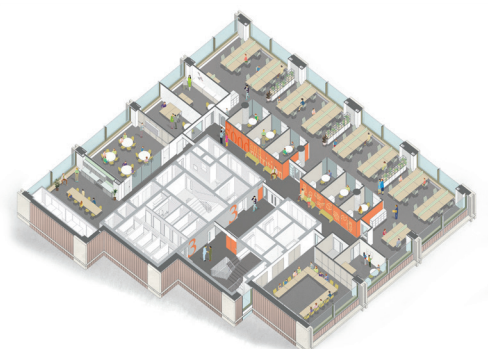

The School of Public Health aims to achieve better health in the population through strengthening the public health science base, training the next generation of public health leaders and influencing health policies in the world. Their new home will comprise teaching, research and community outreach space for the School's multidisciplinary research at local, national and international levels.

The wider design team includes structural engineers Curtins, building services engineering consultancy Hoare Lea, Buro Happold is facade engineer and the landscape architect is Gross Max. The School of Public Health will be Allies and Morrison's second building for Imperial College London with the neighbouring Sir Michael Uren Hub having been completed in 2019. The practice has also been supporting the College in developing masterplan proposals for the White City Campus South Site and South Kensington Campus.

Location	London, UK
Uses	Education, Health
Client	Imperial College London
Status	Current
Size	7,940 sqm
Expertise	Architecture
Collaborators	Curtins, Hoare Lea, Buro Happold, Gross Max

ABOUT IMPERIAL COLLEGE LONDON

Imperial College London is a public research university in the United Kingdom. It delivers world-class scholarship, education and research in science, engineering, medicine and business, with particular regard to their application in industry, commerce and healthcare. Since its foundation in 1907, Imperial has enjoyed a reputation for excellence in education and research that today attracts over 6,000 staff and 14,000 students of international quality.

[imperial.ac.uk](https://imperial.ac.uk) / [@imperialcollege](https://twitter.com/imperialcollege)

ABOUT ALLIES AND MORRISON

Allies and Morrison is a practice of architects and urbanists based in London and Cambridge. We design beautiful buildings that have long life and can adapt over the generations. We also shape enduring places whether new pieces of city or settlements at any scale. All our projects are concerned with the crafting of every detail and the appreciation for the uniqueness of each context.

[alliesandmorrison.com](https://alliesandmorrison.com) / [@alliesandmorrison](https://twitter.com/alliesandmorrison)